

|      |     |
|------|-----|
| Dept | Qty |
| DC   | 1   |
| ED   | 1   |
| IE   | 1   |
| ISO  | 1   |
| PD   | 1   |
| R&D  | 1   |
| SD   | 1   |
| QA   | 1   |
| QC   | 1   |
| QE   | 1   |

The information provided herein is from CONNELY Electronic Co., Ltd. and is confidential. Any disclosure to a party other than the recipient is prohibited. The intellectual properties and its rights contained herein, including but not limited to, trademarks, patents, copyrights, trade secrets, and technical know-how, are owned exclusively by CONNELY or its affiliates. Unauthorized use or reproduction of any part of this document is strictly prohibited. CONNELY may enforce its intellectual property rights at its own discretion, failures or delays to exercise such rights does not constitute a waiver of such rights.

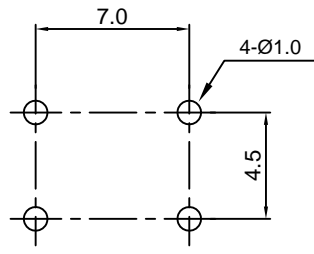

Recommend PCB layout  
Tolerance:±0.05

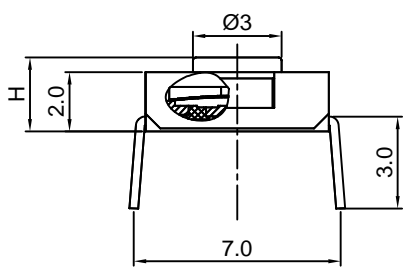
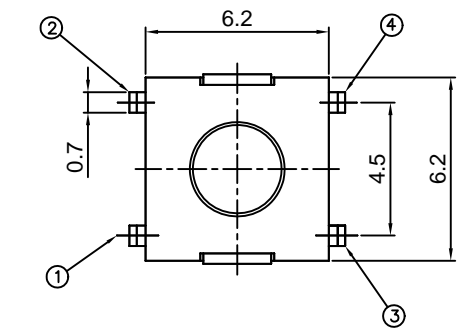
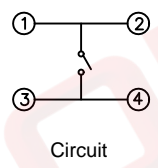

(Series Image-Reference Only)

| REV. | DESCRIPTION    | DRAWN         | CHECKED       | APPROVED      |
|------|----------------|---------------|---------------|---------------|
| A    | NEW RELEASE    | JLZ 03/31/17' | HZW 03/31/17' | LJC 03/31/17' |
| B    | DRAWING UPDATE | JLZ 10/09/20' |               |               |

**NOTES:**

- Specifications
  - Switch Function: Single Pole Single Throw
  - Contact Rating: 50mA at 12Vdc
  - Insulation Resistance:100MΩ min.
  - Contact Resistance:100mΩ max.
  - Operating Life:80,000 cycles
  - Stop Strength: Place The Switch Such That Vertical, A Static Load Of 3Kgf Shall Be Applied In The Direction
  - Operation Temperature Range: -25°C to +70°C
  - Wave Soldering: Recommended Solder Temperature At 500°F(260°C)max. 5 Seconds, Subject To pcb 1.6mm Thickness.
  - Hand Soldering: Use Soldering Iron Of 30 Watts, Controlled At 608°F(320°C) Approximately 2 Seconds.

2. Product number code:

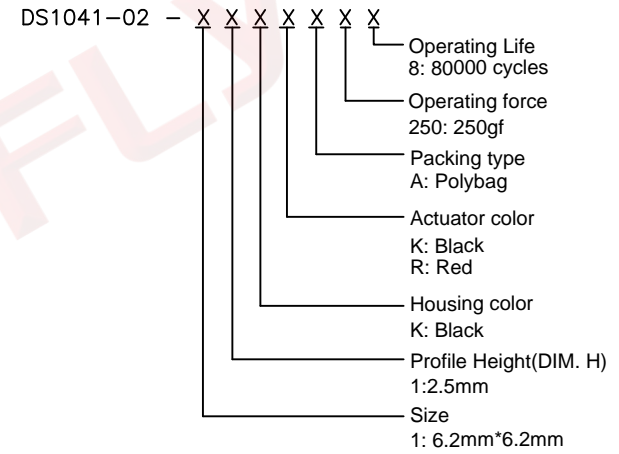

|                   |       |                      |       |            |    |        |                                  |  |
|-------------------|-------|----------------------|-------|------------|----|--------|----------------------------------|--|
| GENERAL TOLERANCE |       | ANGLE TOLERANCE      |       | PROJECTION |    | TITLE  | Tact Switch DIP Type 6.2mmX6.2mm |  |
| X.                | ±0.60 | X.                   | ±5°   | UNITS      | mm |        |                                  |  |
| .X                | ±0.38 | .X                   | ±3°   | SHEET SIZE | A4 | SERIES | DS1041-02 SERIES                 |  |
| .XX               | ±0.25 | .XX                  | ±2°   |            |    |        |                                  |  |
| DRAWING TYPE      |       | CUSTOMER             |       |            |    |        |                                  |  |
| SCALE             |       | 1:1                  | SHEET | 1 OF 1     |    |        |                                  |  |
| DRAWING NO.       |       | C-DS1041-02-XXXXXX-B |       |            |    |        |                                  |  |

