

The information provided herein is from CONNELY Electronic Co., Ltd. and is confidential. Any disclosure to a party other than the recipient is prohibited. The intellectual properties and its rights contained herein, including but not limited to, trademarks, patents, copyrights, trade secrets, and technical know-how, are owned exclusively by CONNELY or its affiliates. Unauthorized use, reproduction, or distribution of this information is strictly prohibited. CONNELY may enforce its intellectual property rights at its own discretion, failures or delays to exercise such rights does not constitute a waiver of such rights.

REV.	DESCRIPTION	DRAWN	CHECKED	APPROVED
A	NEW RELEASE	LL 10/09/06		LJC 10/09/06
D	DRAWING UPDATE	JLZ 05/04/18'		

**Female Terminal**

T-DS1072- S C 6 0 0  
 Contact Plating  
 6: Tin

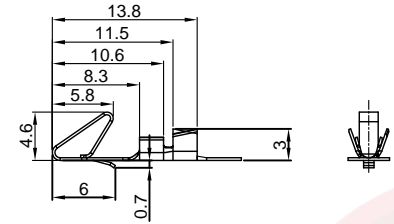

**Female Terminal**

Wire Range	O.D of Wire	
Section Area (mm) <sup>2</sup>	AWG#	mm
0.2-0.75	24-18	1.3-2.8

**Female Housing**

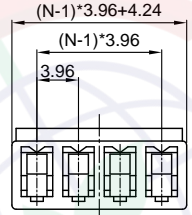
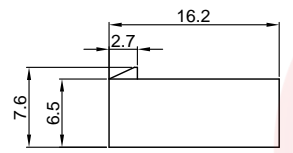

I-DS1072- S C T 0 X  
 No. of contact  
 02-13

**NOTES:**

- MAIN SPECIFICATIONS
  - Housing material: NYLON 66
  - Wire range: AWG#24-#18
  - Rated voltage: 250V
  - Rated current: 7A(18AWG)
  - Contact resistance: 30mΩ Max
  - Insulation resistance: 1000MΩ Min
  - Withstanding voltage: 1000V, AC 1 minute
  - Temperature range: -25 ~ +85°C
  - Recommend PC board thickness: 1.6mm
- PRODUCT NUMBER CODE:
  - DS1072 - X X X X X

**Male Right Angle**

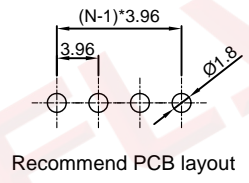
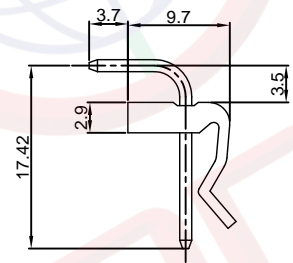
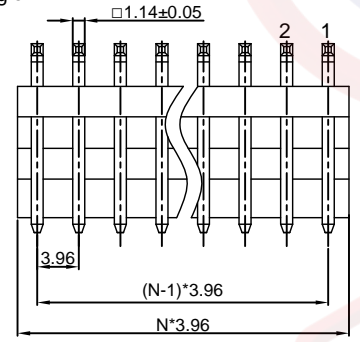

**Male V/T TYPE**

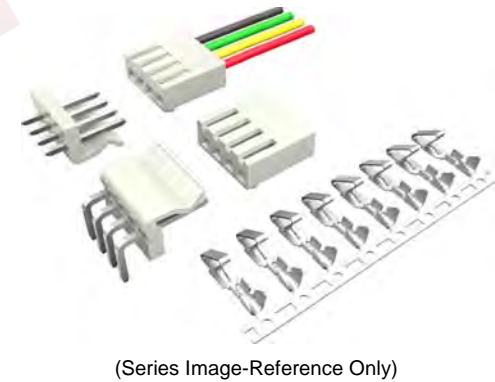
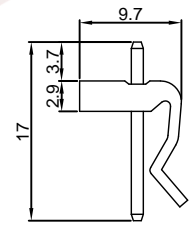
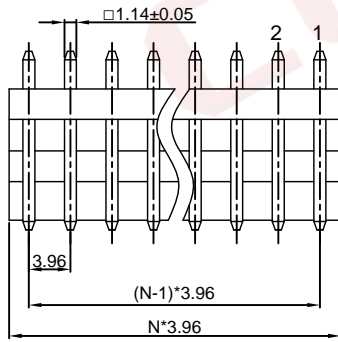

- Contact Plating  
6: Tin  
8: Full gold flash
- Housing Color  
T: Transparent
- Mounting type  
R: Right Angle  
V: V/T type
- Connector type  
M: Male
- No. of contact  
2 to 13

N=No. of contacts

GENERAL TOLERANCE		ANGLE TOLERANCE	
X.	±0.60	X.	±5°
.X	±0.38	.X	±3°
.XX	±0.25	.XX	±2°

DRAWING TYPE	CUSTOMER		
SCALE	1:1	SHEET	1 OF 1
DRAWING NO.	C-DS1072-XXXXX-D		

PROJECTION		TITLE	P.C.B CONNECTOR Pitch 3.96mm	
UNITS	mm	SERIES	DS1072 SERIES	
SHEET SIZE	A4			

**晨翔电子有限公司**  
 CONNELY CONNELY ELECTRONIC CO. LTD