

Dept	
Qty	
DC	1
ED	1
IE	1
ISO	1
PD	1
R&D	1
SD	1
QA	1
QC	1
QE	1

The information provided herein is from CONNELY Electronic Co., Ltd. and is confidential. Any disclosure to a party other than the recipient is prohibited. The intellectual properties and its rights contained herein, including but not limited to, trademarks, patents, copyrights, trade secrets, and technical know-how, are owned exclusively by CONNELY or its affiliates. Unauthorized use of this information in any format or manner. CONNELY may enforce its intellectual property rights at its own discretion; failures or delays to exercise such rights does not constitute a waiver of such rights.

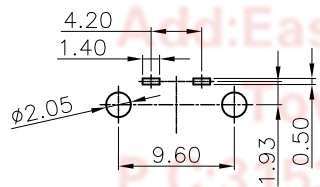
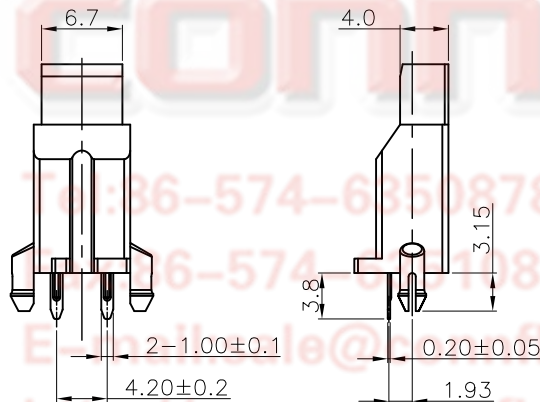
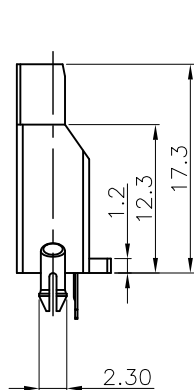
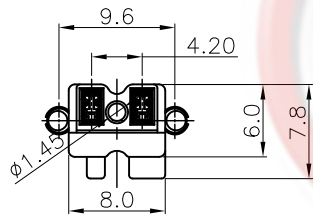
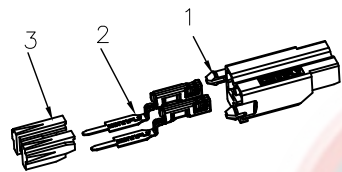

RECOMMEND PCB LAYOUT  
(TOLERANCE=±0.05)

REV.	DESCRIPTION	DRAWN	CHECKED	APPROVED
A	NEW RELEASE	JLZ 08/10/18'		

NOTES:

- ELECTRICAL CHARACTERISTICS:
  - CONTACT RESISTANCE: 260mΩ Max.
  - DIELECTRIC WITHSTANDING VOLTAGE: 500V AC(rms) FOR 1 MINUTE.
  - INSULATION RESISTANCE: 100MΩ Min.
  - CURRENT RATING:1A.
  - VOLTAGE RATING:30V DC.
- ENVIRONMENT CHARACTERISTICS:
  - TEMPERATURE: -25°C~+70°C.
- MATERIALS
  - CONTACT MATERIAL: COPPER ALLOY, GOLD OVER NICKEL PLATED.
  - INSULATOR MATERIALS: NYLON/PC GRAY/BLACK/RED.

4. PRODUCT NUMBER CODE:

DS1092-28 - X X X X 0 X 0

- Packing Type  
P:Polybag
- Housing Color  
A:Gray  
B:Black  
R:Red
- Contact Plating  
8:Gold Flash
- Mounting Type  
V:V/T Type
- Connector Type  
S:Socket

GENERAL TOLERANCE		ANGLE TOLERANCE	
X.	±0.60	X.	±5°
.X	±0.38	.X	±3°
.XX	±0.25	.XX	±2°

PROJECTION		TITLE	4.2mm Travel Switch V/T Type
UNITS	mm		H=17.3mm
SHEET SIZE	A4	SERIES	DS1092-28 SERIES

ITEM	PART NAME	MATERILAS	FINISHED
3	COVER	NYLON	BLACK UL94 V-0
2	CONTACT	COPPER ALLOY	GOLD FLASH
1	HOUSING	NYLON	BLACK UL94 V-0

DRAWING TYPE	CUSTOMER		
SCALE	1:1	SHEET	1 OF 1
DRAWING NO.	C-DS1092-28-XXXXX0X0-A		

晨翔电子有限公司  
CONNFLY CONNELY ELECTRONIC CO. LTD